

With this component the flushing function is fully guaranteed. When the vessel is disconnected from the system the system flow remains in function. Airfixcontrol enables an easy yearly precharge check of the Airfix A or D expansion vessel.

DVWG certification applied in combination with Airfix A or Airfix D.

- Complete connector set including shut-off and drain.

Advantages

- For contact with potable water this isolator consists of materials approved by the relevant authorities.
- Integrated vessel draining facility for yearly pre-charge check without vessel removal.
- In closed position the flow remains intact and system remains pressurized.

Technical Specifications

- Maximum water temperature: 70 °C.
- Maximum working pressure: 10 bar.



Description	Airfix Control	
Order Code	28930	
GTIN	8712874289307	
Model	<u>Airfixcontrol</u>	
Connections	A	G $\frac{3}{4}$ " M
	B	G $\frac{3}{4}$ " F
Dimensions	C [mm]	71
	D [mm]	29
	E [mm]	34
Weight [kg]	0.24	

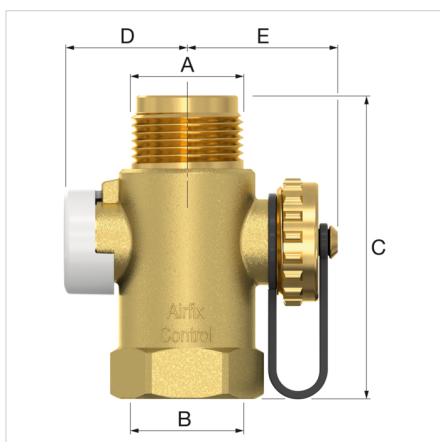

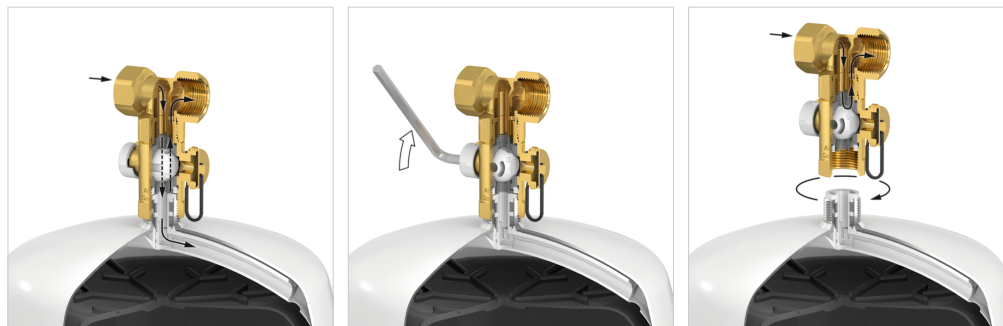

Classification General Data

Etim Group	Pressurization and expansion systems
Etim Class	Accessories/spare parts for pressure expansion vessel
Product Name	AirfixControl
Brand	Flamco
Product Type	Accessories
Order Code	28930
GTIN	8712874289307

Find more information online:

[Installation and operating instruction](#)

[Packaging data](#)

Attributes

Type of accessory/spare part	Pressure control
Accessory	Yes
Spare part	No
Model	Pressure control

Fort Blauwkapel 1
1358 DB, Almere - nl

T +31 (0)36 52 62 300
E info@aalberts-hfc.com
I flamco.aalberts-hfc.com